

Tuesday Posters

Poster#	school	poster title	day	#	Category	Presenters	Authors
1	UT	A Framework for Dynamic Modeling and Simulation of Shipboard HVAC Strategies	T	1	Thermal	Dr. Thomas Kiehne	Dr. Thomas Kiehne, Patrick Hewlett, Patrick Paullus, Michael Pierce, Matthew Pruske
2	FSU	Geometry Optimization of Flow Channels with Asymmetric Bifurcations	T	2	thermal	J.C. Ordonez/ J.A. Souza	S. Kosaraju and J.C. Ordonez
3	FSU	Design, Modeling, and Simulation of Fuel Cells and Fuel Cell Systems	T	3	thermal	J.C. Ordonez/ J.A. Souza	L. Martins, H. Wen, T. Brinson, S. Kosaraju, J.C. Ordonez, J.V.C. Vargas
4	USC	Development of a Piezoelectric micropump and microchannel heat sink with integrated micropumps for thermal management	T	4	Thermal	M. Yakut Ali	M. Yakut Ali, Guiren Wang, Jamil Khan
5	USC	System Level Co-simulation of Ship's Hybrid power System and Thermal Plant	T	5	Thermal	Ruixian fang/ Muhammad Ali	Ruixian Fang, Wei Jiang, Jamil Khan, Roger Dougal
6	USC	Effects of Inductive Fault Current Limiter on Generator Synchronization	T	6	protection/grounding	Yucheng Zhang	Yucheng Zhang, Roger A. Dougal
7	USC	PCT based detection of faulty sensor and information reconstruction	T	7	Monitoring/Communications	H. Li	H. Li, A. Monti
8	USC	Condition Monitoring of Electric Ship Power Cable via Joint Time-Frequency Domain Reflectometry	T	8	Monitoring/Communications	Jingjiang Wang	Jing-Jiang Wang, Philip Stone
9	FSU	Condition Based Maintenance Using Soft Computing Techniques.	T	9	Monitoring/Communications	Shailabh Mazari	Shailabh Mazari, Dr. Chris Edrington, and Dr. Sanjeev Srivastava
10	USC	A Decentralized Observer for Ship Power Systems Application: Implementation and Experimental Validation	T	10	Monitoring/Communications	Ugo Ghisla	Andrea Benigni, Ugo Ghisla, Gabriele D'Antona, Antonello monti, Ferdinanda Ponci
11	MSU	Investigation of Communication Options for Real Time Power System Distributed Simulation	T	11	Monitoring/Communications	Krishnanjan G. ravijumar	Krishnanjan G. Ravikumar, Noel N. Schulz, and Anurag K. Srivastava
12	MSU	Partitioning and Interface Requirements between System and Application Control of Power Electronic Converter Systems	T	12	power electronics	Anil K Kondabathini	Anil K Kondabathini
13	USC	Predictive Control of an Interleaved DC-DC Converter	T	13	power electronics	Daniel Martin	Daniel Martin, Adam Barkley
14	FSU	Utilizing Hardware-in-the-Loop Simulation for Power Electronics Controller Upgrades	T	14	power electronics	Dominik Neumayr	Dominik Neumayr
15	MSU	Control of Circulating Current in a Multi-Converter System with Parallel 3-phase PWM Converters Having Different Control Objectives	T	15	power electronics	G. Dehnavi	G. Dehnavi, H. Ginn
16	FSU	Development of a virtual machine for advanced motor drive evaluations	T	16	power electronics	Fletcher Flemming	Fletcher Flemming
17	USC	Mult-Agent Control of multi-functional PEBB based Power Electroni Systems	T	17	power electronics	Jian Ma	Jain Ma, Ferdi Ponci, and Herb Ginn
18	USC	Validation of IGBT Physics-Based Model Under Soft Switching Conditions	T	18	power electronics	Ruiyun Fu	Ruiyun Fu, Enrico Santi
19	USC	Network based control of Power Electronics Systems	T	19	power electronics	Rong Liu	R. Liu, A. Smith, F. Ponci, A. Monti
20	FSU	Reconfigurable Active Front-End of Adjustable Speed Drives for Power Quality Improvement	T	20	power electronics	Sanjeev Srivastava	Siyu Leng, Il-Yop Chung, Wenxin Liu, and David Cartes
21	MSU	Power electronic Interface of Multiple Energy Sources to Utility Grid	T	21	power electronics	Shravana Musunuri	Shravana Musunuri, Herb Ginn, Noel Schulz
22	USC	Multi-FPGA System for ultra-fast simulation	T	22	power electronics	Yan Shi	Yan Shi, A. Monti
23	MSU	Reconfiguration of Shipboard MVDC Network	T	23	power systems	R.Arghandeh	R. Arghandeh, N. Schulz, A. Srivastava
24	MSU	Modeling and Simulation of Shipboard Power System Protection Scheme	T	24	protection/grounding	Ankush Saran	Ankush Saran, Anurag K. Srivastava, Noel N. Schulz

Poster#	school	poster title	day	#	Category	Presenters	Authors
25	FSU	Feasibility Study of Noise Pattern Analysis based Ground Fault Locating Method for Ungrounded DC Shipboard Power Distribution Systems	T	25	protection/grounding	Yan Pan	Yan Pan
26	FSU	Geographically Distributed Thermo-Electric Co-Simulation of All-Electric Ship	T	26	Thermal	Omar Faruque	Omar Faruque
27	MSU	OPTIMAL CONTROL OF VOLTAGE AND POWER IN A MULTI-ZONAL SHIPBOARD MVDC POWER SYSTEM	T	27	power systems	Padmavathy Kankanala	Padmavathy Kankanala, Suresh C. Srivastava, Anurag K. Srivastava and Noel N. Schulz
28	FSU	Algorithm development for evaluating IPS topological survivability	T	28	power systems	Svetlana V. Poroseva	S. V. Poroseva, N. Lay, and M. Y. Hussaini
29	FSU	Hardware-in-the-Loop Experiments with a Simulated Electric Ship Power System Utilizing a 5 MW Variable Voltage Source Converter Amplifier	T	29	power systems	Mike Sloderbeck	Mike Sloderbeck
30	MSU	VOLTAGE STABILITY ANALYSIS OF DISTRIBUTION SYSTEM USING THREE PHASE CONTINUATION POWER FLOW	T	30	power systems	Shilpa Toppo	Shilpa Toppo, D. Khaniya, Anurag K. Srivastava and Noel N. Schulz
31	USC	A Solid State Defender for DC Power Systems against Voltage Instabilities and Faults	T	31	power systems	Ugo Ghisla and Igor Kondratiev	Ugo Ghisla, and Igor Kondratiev
32	MSU	Small Signal Stability of a MVDC Power System	T	32	power systems	Seetharama R Rudraraju	Seetharama R Rudraraju, Anurag K Srivastava, Suresh C Srivastava, Noel N Schulz
33	USC	DC bus stabilization by positive feedforward control	T	33	power systems	Hyoung Y. Cho	Hyoung Y. Cho, Dr. Enrico Santi
34	FSU	Real-time Simulation-based Design of a Power-Hardware-in-The-Loop Setup to Support Studies of Shipboard MVDC Issues	T	34	power systems	Mike Andrus	Mike Andrus
35	USC	Combining Latency Insertion with Traditional Simulation Methods for Large System Analysis	T	35	power systems	Dr. Roger Dougal	A. Benigni, A. Monti, R. Dougal

WEDNESDAY ' S POSTERS

Poster#	school	poster title	day	#	Category	Presenters	Authors
36	UT	Thermal-Electrical Co-Simulation of Shipboard Integrated Power Systems	W	1	Thermal	Dr. Thomas Kiehne and Michael Pierce	Dr. Thomas Kiehne and Matthew Pruske
37	FSU	Volume Element Based System for All-Electric Ship Thermal Simulation and Visualization	W	2	Thermal	J.A. Souza and J.C. Ordóñez	J. A. Souza, J. C. Ordóñez, R. Hovsopian, J.V.C. Vargas, and F. G. Dias
38	UT	Framework for Dynamic Thermal Modeling and Simulation of Shipboard Systems	W	3	Thermal	Michael Pierce	Dr. Thomas Kiehne, Pete Backlund, Patrick Hewlett, Patrick Paullus, Michael Pierce, Matthew Pruske
39	USC	Experimental heat transfer enhancement of micro-channel cooling using a synthetic jet actuator	W	4	thermal	Ruixian fang/ Muhammad Ali	Ruixian Fang, Wei Jiang, Jamil Khan, Roger Dougal
40	MSU	Simulation Environment for Dynamic Thermal Modeling and Simulation Framework	W	5	thermal	Tomasz Haupt	Tomasz Haupt, Gregory Henley, and Bhargavi Parihar
41	MSU	Cognitive Data Analysis of a Decision Support System for Real-Time Adaptive Power System Reconfiguration	W	6	design	Charles Stewart	Venkata Krishna Pendurthi, Charles Stewart*, Dr. Noel Schulz, Dr. Anurag Srivasta, Dr. Stephanie Doane
42	FSU	Uncertainty analysis methods for ship system design	W	7	design	James Langston	James Langston
43	Purdue	Optimization of Wound-Rotor Synchronous Machines using a Mesh-Based Magnetic Equivalent Circuit	W	8	gen/storage	Michelle Bash	Michelle Bash, Scott Sudhoff
44	USC	Integrated power/communication simulation for designing protection in MVDC systems	W	9	protection/grounding	Roger Dougal	A. Monti, R. Dougal
45	Purdue	Hybrid Model Predictive Control of a DC-DC Boost Converter	W	10	power electronics	Jason Neely	Jason Neely and Scott Sudhoff
46	Purdue	Medium Voltage DC Test Bed: Power Supply 1 (PS-1)	W	11	gen/storage	Jason Neely	Jason Neely and Scott Sudhoff
47	FSU	Investigating shipboard electrical grounding issues	W	12	protection/grounding	Dorca Lee	Dorca Lee
48	USC	Automated Nonintrusive Wireless Sensors for Power System Monitoring	W	13	Monitoring/Communications	Rashed H. Bhuiyan	Rashed H. Bhuiyan, Mohammad Ali, and Roger A. Dougal
49	Purdue	Structural Magnetics Tedbed for Study of Ship Field Distribution	W	14	design	Jacob Krizan	Jacob Krizan and Scott Sudhoff
50	USC	Online Monitoring of Power System Impedances	W	15	Monitoring/Communications	Adam Barkley	Adam Barkley, Advisor: Dr. Enrico Santi
51	Purdue	Medium Voltage DC Test Bed: Pulsed Power Load	W	16	design	Jonathan Crider	Jonathan Crider and Scott Sudhoff
52	Purdue	A Medium Voltage DC Testbed	W	17	design	Jonathan Crider	Jonathan Crider and Scott Sudhoff
53	USC	Synchronous Motor Field Oriented Control for Gas Turbine Emulation	W	18	gen/storage	Blanca A. Correa	Blanca A. Correa, Dr. Roger Dougal
54	MIT	Impact of High Speed Propeller on Overall Electric Ship Design	W	19	gen/storage	Julie Chalfant	J. S. Chalfant, R. Kimball, C. Chrysostomidis
55	USC	Battery/Supercapacitor Energy Storage System	W	20	gen/storage	J Stephen Kowski	J Stephen Kowski
56	MSU	Electrical degradation of 15 kv XLPE and EPR cables energized by switching impulses	W	21	materials	Linfeng Cao/ B. Pushpanathan	S. Grzybowski, L.Cao, and B. Pushpanathan
57	FSU	Dielectric Breakdown of Transformer Insulation Materials at Room and Cryogenic Temperatures	W	22	materials	Horatio Rodrigo	H. Rodrigo, W. Baumgartinger, A. Ingrole, R. Liang, D.G. Crook, and S. L. Ranner
58	MSU	Accelerated Electrical Degradation of Machine Winding Insulation	W	23	materials	Sajal R. Chalise	S.R Chalise, S.Grzybowski, and C.D. Taylor

Poster#	school	poster title	day	#	Category	Presenters	Authors
59	MSU	Extension of CIM for shipboard power systems	W	24	design	Vinoth Mohan	Vinoth Mohan, Anurag Srivastava, Noel Schulz
60	MIT	An End-to-End Simulator for the All-Electric Ship Integrated Power System	W	25	design	Mirjana Milosevic Marden	Mirjana Milosevic Marden, Pradya Prempraneerach, Chryssostomos Chryssostomidis, James Kirtley, George Karniadakis
61	FSU	A New Wide-Area Protection Method in Power Systems: Towards Automation	W	26	power systems	Svetlana V. Poroseva	D. Dustegor, S. V. Poroseva, J. Langston, M. Y. Hussaini
62	MSU	Control of Multiple Generators for the All-Electric Ship	W	27	power systems	Yamilka Baez-Rivera	Yamilka Baez-Rivera and Noel N. Schulz
63	FSU	Notional MVDC system development on RTDS	W	28	power systems	Mike Andrus	Mike Andrus
64	MIT	Induction Motors Driving High Speed Propellers	W	29	power electronics	Jim Kirtley	Steven Englebretson, James Kirtley, Jr., and Chryssostomos Chryssostomidis
65	USC	Harmonic Disturbance Flow in Various Architectures of an Electric Ship Integrated Power System	W	30	power electronics	Philip Stone	Philip Stone and Dr. Yong-June Shin
66	FSU	Advanced Converter Power/Energy Management	W	31	power electronics	Liming Liu	Liming liu, Hui Li
67	MSU	Current Sharing to Minimize Power Losses in Parallel Converters with PSO	W	32	power electronics	Dan Li	Dan Li and Herbert Ginn
68	MIT	Optimizing network statistics for robustness in electric ship designs	W	33	design	Josh Taylor	Josh Taylor and Franz Hover
70	MIT	Hardware model of a shipboard generator	W	35	gen/storage	Greg Elkins	Greg Elkins, Steven Leeb, Jim Paris, Zach Remscrim, Rob Cox
69	MIT	Modeling for Ship Power System Emulation	W	34	Design	Jeremy Leghorn	Jeremy Leghorn, Steven Leeb, Jim Paris, Zach Remscrim, Rob Cox
71	MIT	Scalability of Non-Intrusive Load Monitoring for Shipboard Applications	W	36	Monitoring/Comm unications	Keith Douglas	Keith Douglas, Steven Leeb, Jim Paris, Zach Remscrim, Rob Cox

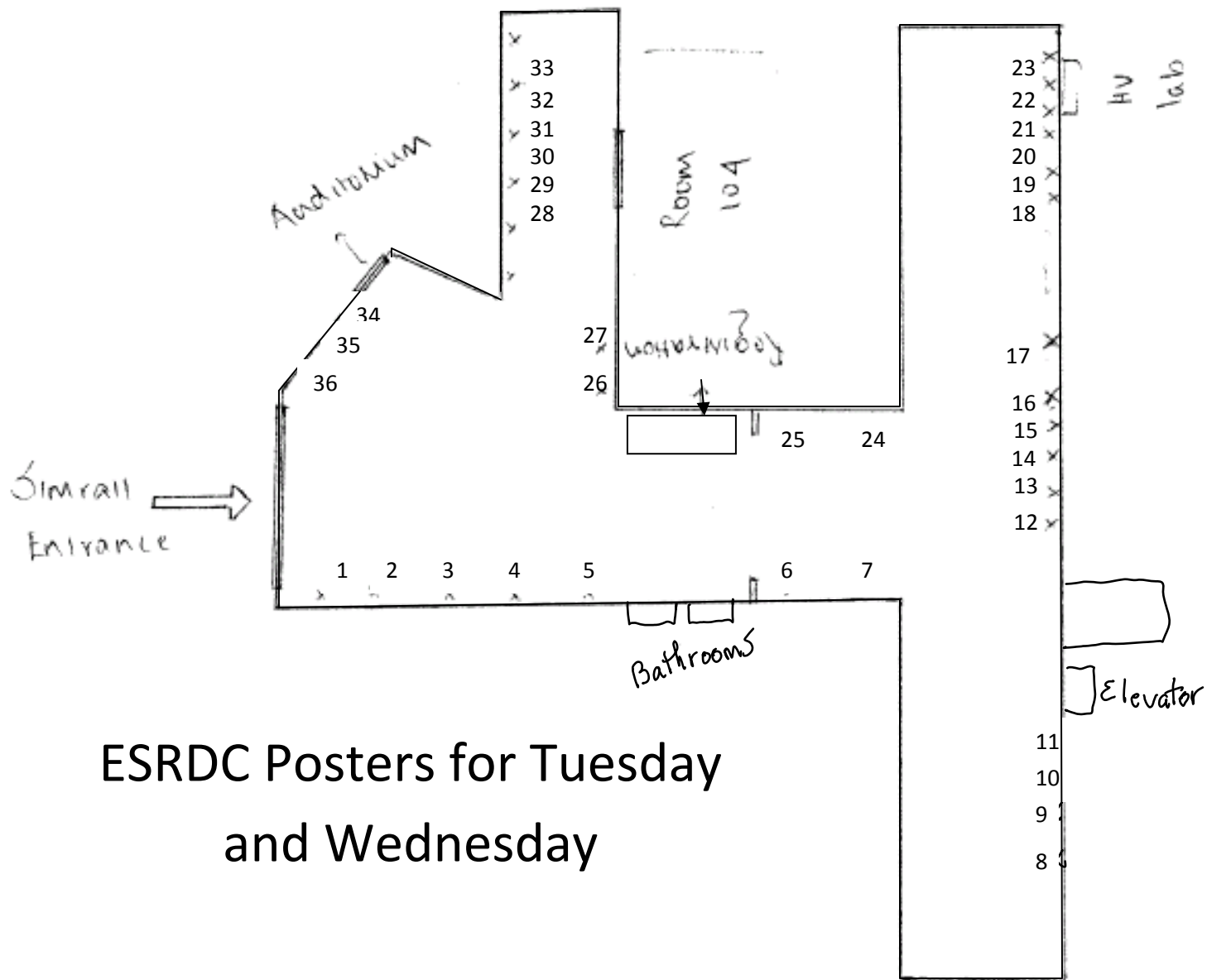

ESRDC Posters for Tuesday
and Wednesday